

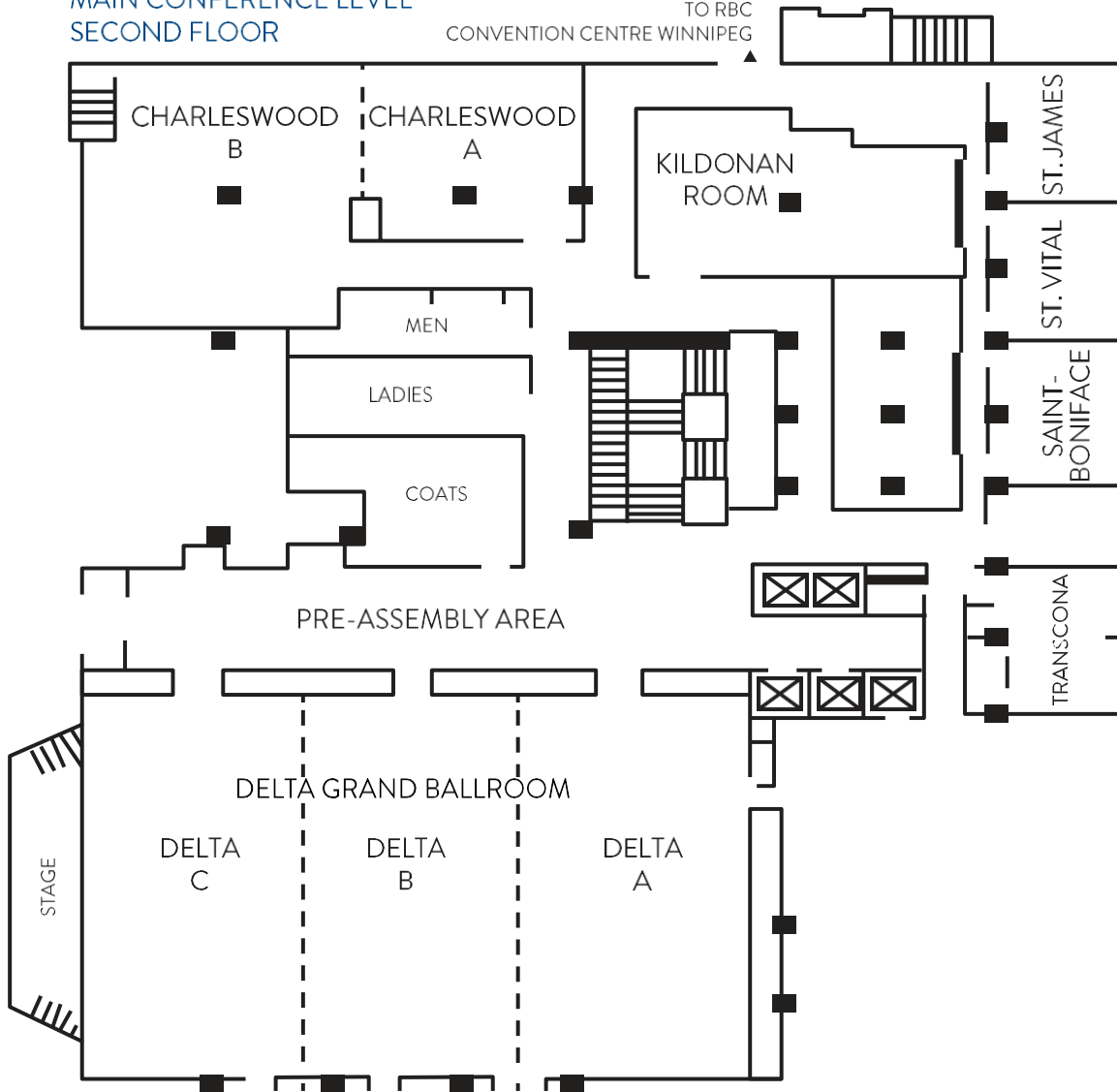

MAIN CONFERENCE LEVEL  
SECOND FLOOR

TO RBC  
CONVENTION CENTRE WINNIPEG



| Meeting Space        | W X L X H   | Sq.Ft |
|----------------------|---|-------|
| DELTA GRAND BALLROOM | 110' x 66' x 20'                                  | 7260  |
| DELTA A +            | 36' x 66' x 9-20"                                 | 2376  |
| DELTA B +            | 36' x 66' x 20'                                   | 2376  |
| DELTA C +            | 38' x 66' x 20'                                   | 2508  |
| 2 SECTIONS +         | 65' x 132" X 16'                                  | 4357  |
| GRAND BALLROOM FOYER | 60' x 90'   | 900   |
| CHARLESWOOD P        | 77' x 30' x 9'                                    | 3110  |
| CHARLESWOOD A ^      | 30' x 37' x 9'                                    | 1110  |
| CHARLESWOOD B ^ P    | 50' x 40' x 9'                                    | 2000  |
| KILDONAN P           | 21' x 29' x 9'<br>10' x 25' x 9'<br>9' x 20' x 9' | 1061  |
| SAINT-BONIFACE       | 21' x 24' x 9'                                    | 504   |
| ST. VITAL            | 21' x 24' x 9'                                    | 504   |
| ST. JAMES            | 21' x 24' x 9'                                    | 504   |
| TRANSCONA            | 20' x 24' x 9'                                    | 408   |